

living & dining table of contents

Occasional Tables 36
 Cottage Cupboards..... 38
 Shaker Cupboards 39
 Jelly Cupboards 40
 Tall Country Cupboard..... 42
 Consoles & Stands 43
 Country Hutch & Buffet 44
 Traditional Hutch & Buffet 46
 Corner Cupboard Country 47
 Corner Cupboard Traditional 48
 Corner Cupboard 50

Microwave Cabinets 50
 Wine Cabinet 51
 Recycle Cabinets..... 51
 Kitchen Islands 52
 Benches..... 54
 Display Case 54
 Curio 55
 Gun Cabinets 55
 Semi-Custom..... 56
 Wall Cabinets 60
 Wall Accessories..... 62

Wood Letter Codes: maple: (m) oak: (k) cherry: (c)



Drawers solid wood drawers feature English dovetail joints for lasting stability and are mounted on easy-rolling full extension ball bearing drawer glides.

Maple a light colored hardwood, Maple has a close, fine, uniform texture that is generally straight-grained. A very durable hardwood that will take any color stain or paint well.

Oak has a reddish cast and is a very hard wood with a mostly straight open grain. This is an extremely durable, great wear-resistance hardwood that accepts stains well to a beautiful finish.

Cherry a beautiful reddish brown to deep red color with lighter streaks of sapwood. Cherry has a fine uniform, straight grain, satiny, smooth texture, the beauty of this hard wood and accompanying even grain has been a favorite choice of furniture makers for centuries.

Woodcraft quality hardware options vary by style and collection. Your choices will be displayed on our collection pages.



Brushed Nickel Cup Pull **BN**



Modern Chrome Pull **MC**



Wood Knob **W**



Antique Brass Knob **AB**



Brushed Nickel Knob **BN**



Antique Brass Cup Pull **AB**



Black Cup Pull **BL**



Black Knob **BL**



Traditional Knob **TD**

Model Numbers

The model number at right reflects a maple, Shaker, occasional table.

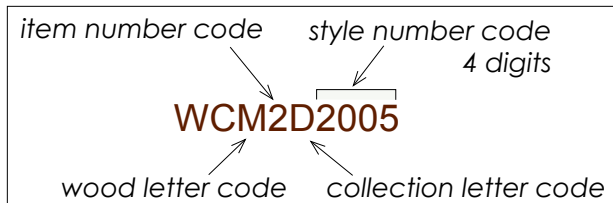

living & dining

Cottage features solid wood turned feet, beadboard side panels & wood knobs. Available in banded or solid wood tops and maple (**m**) wood.

Shaker solid wood tops and post construction, flat panel doors with wood knobs, available in maple (**m**), oak (**k**) or cherry (**c**) wood.

Country a best seller offers solid wood raised panel doors and wood knobs, available in maple (**m**) or oak (**k**).

Traditional solid wood raised panel doors and brass knobs, available in maple (**m**) or oak (**k**). Optional mitered doors.



Woodcraft living room and dining room furniture is built using premium grades of maple (m), oak (k) and cherry. The solid wood drawers feature dovetail joints and easy-rolling, ball bearing glides for lasting stability. Your choice of hardware styles on select collections.



Manhattan Sofa Table shown in
Cherry Wood WC_2Q2051

Manhattan Tables

occasional tables are available in: Maple (m), Oak (k), or Cherry (c)



Sofa Table

WC_2Q2051

46"W X 30 1/2"H X 14 3/4"D
5/4 LEG
SOLID TOP

Coffee Table

WC_2Q2052

41 1/2"W X 18 3/4"H X 20"D
5/4 LEG
SOLID TOP

End table

WC_2Q2050

23 1/2"W X 25 3/4"H X 20"D
5/4 LEG
SOLID TOP



Coffee Table
WC_2Q2052



End table
WC_2Q2050

Shaker Tables

occasional tables are available in: Maple (m), Oak (k), or Cherry (c)



Side Table WC_2D2020



End Table
WC_2D2005

Side Table

WC_2D2020

14"W X 25 3/4"H X 24"D
1 DRAWER
1 SHELF

Coffee Table

WC_2D2003

41 1/2"W X 18"H X 20 1/4"D
2 DRAWERS

End Table

WC_2D2005

23 1/2"W X 25 3/4"H X 20 1/4"D
1 DRAWER 1 SHELF

Coffee Table

WC_2D2011

42"W X 18"H X 20 3/4"D
OPENING IS 7 1/2" H
1 DRAWER

End Table

WC_2D2010

23 1/2"W X 25"H X 20 3/4"D
OPENING IS 7 1/2" H
2 DRAWERS

Sofa Table

WC_2D2006

50"W X 30"H X 14 1/2"D
2 DRAWERS
1 SHELF



End Table WC_2D2010



Coffee Table
WC_2D2011



Coffee Table
WC_2D2003



Sofa Table
WC_2D2006

occasional tables



End Table
with Glass Top
WC_2B2010



Coffee Table with Glass Top
WC_2B2011



Sofa Table with Glass Top
WC_2B2012



Side Table
WC_2B2020



End Table
WC_2B2002



Sofa Table WC_2B2004



Full extension, ball-bearing
drawer glide.



Wood Knob W

Choose from our beautiful selection of solid wood occasional tables to enhance the flow and function of your living spaces.

Glass Top Tables

occasional tables are available in: maple (m) and oak (k)



End Table
with Glass Top
WC_2B2010

23 1/2"W X 25 3/4"H X 20 1/4"D
1/4" THICK TEMPERED GLASS

Coffee Table
with Glass Top
WC_2B2011

45"W X 18"H X 25"D
1/4" THICK TEMPERED GLASS

Sofa Table
with Glass Top
WC_2B2012

46 1/4"W X 30"H X 18"D
1/4" THICK TEMPERED GLASS

Country Tables

occasional tables are available in: maple (m) and oak (k)



Side Table
WC_2B2020
14"W X 26"H X 24"D
2 DRAWERS
1 SHELF

Coffee Table
WC_2B2001
46 1/4"W X 18"H X 18 3/4"D
3 DRAWERS
1 SHELF

End Table
WC_2B2002
19 1/2"W X 25"H X 18 3/4"D
2 DRAWERS
1 SHELF

Sofa Table
WC_2B2004
46 1/4"W X 30"H X 14 1/2"D
3 DRAWERS
1 SHELF



Coffee Table WC_2B2001



Cottage Chimney Cupboard
WC_2E1909

Cottage Cupboards

Cottage style cupboards are available in maple (m) wood.



Chimney Cupboard
WC_2E1909B BANDED
WC_2E1909S SOLID
21 3/4"W X 72"H X 15"D
2 ADJUSTABLE SHELVES
2 DRAWERS
2 DOORS

Cottage Cupboard
WC_2E0505B
43"W X 72"H X 19 1/2"D
SOLID WOOD MULLIONS
2 FIXED SHELVES
2 DOORS
4 DRAWERS

Glass Drawer Cabinet
WC_2E1914B BANDED
WC_2E1914S SOLID
33 1/2"W X 50 1/2"H X 19"D
GLASS PANEL DRAWER FRONTS
BOX JOINT DRAWERS
FLAT PANEL WOOD FRONTS
1 ADJUSTABLE SHELF
BLACK HARDWARE



Cottage Cupboard
WC_2E0505

Cottage Stand
WC_2E2005B BANDED
WC_2E2005S SOLID
50"W X 30"H X 13"D
1 ADJUSTABLE SHELF
2 DRAWERS



Cottage Stand
WC_2E2005



Full extension, ball-bearing
drawer glide.



Wood Knob W



Cottage Glass Drawer Cabinet
WC_2E1914



Cottage Stand
WC_2E2005

cupboards

Woodcraft offers an attractive selection of storage cabinets so you can create beautiful places to organize your life.



Cottage
Chimney Cupboard
WC_2E1909



Cottage
Glass Drawer Cabinet
WC_2E1914



Shaker Cabinet WC_2D1903



Shaker Cabinet
WC_2D1904



Shaker Cabinet
WC_2D1903

Shaker Cupboards Shaker cupboards have banded wood tops available in: maple (**m**), oak (**k**) and cherry (**c**) wood.

Shaker Cabinet
WC_2D1904
24"W X 41"H X 15 3/4"D
1 ADJUSTABLE SHELF
2 DRAWERS
BANDED TOP

Shaker Cabinet
WC_2D1903
28"W X 36 1/4"H X 17 3/4"D
1 ADJUSTABLE SHELF
1 DRAWER
SOLID TOP

Wine Cabinet
WC_2D2701
23 1/2"W X 35 1/2"H X 20 1/4"D
HOLDS 8, 750 ML BOTTLES
STEMWARE RACK
BANDED TOP



Wine Cabinet
WC_2D2701



Shaker Console
WC_2D1902

Shaker Console
WC_2D1902
47 1/4"W X 30"H X 15 3/4"D
1 ADJUSTABLE SHELF
BANDED TOP



Country Cupboards

Country cupboards are available in: maple (m) and oak (k) wood.



Cupboard
WC_2B1910

Jelly Cupboard
WC_2B1909
26 1/2"W X 58"H X 12 3/4"D
FLAT PANEL DOORS
4 ADJUSTABLE SHELVES

Jelly Cupboard
with Drawer
WC_2B1910
24"W X 55 3/4"H X 13"D
3 ADJUSTABLE SHELVES
FLAT PANEL DOOR

2 Door
Jelly Cupboard
WC_2B1911
40 1/2"W X 58"H X 12 3/4"D
FLAT PANEL DOORS
4 ADJUSTABLE SHELVES

2 Door
Jelly Cupboard
with Drawer
WC_2B1912
39 3/4"W X 55 3/4"H X 13"D
3 ADJUSTABLE SHELVES
FLAT PANEL DOORS

Pie Safe
WC_2B1915
WITH TIN PANELS
22 1/4"W X 58"H X 12 3/4"D
4 ADJUSTABLE SHELVES

2 Door Pie Safe
WC_2B1919
WITH TIN PANELS
36 1/4"W X 58"H X 12 3/4"D
4 ADJUSTABLE SHELVES



Jelly Cupboard
WC_2B1909



Jelly Cupboard
with Drawer
WC_2B1910



Full extension, ball-bearing
drawer glide.



Wood Knob W



2 Door
Jelly Cupboard
WC_2B1911



2 Door
Jelly Cupboard
with Drawer
WC_2B1912



Pie Safe
WC_2B1915
with tin panels



2 Door Pie Safe
WC_2B1919
with tin panels



cupboards

Our Country Collection is our most popular Living & Dining style and a best seller for it's obvious charm and versatility.



Corner Jelly Cupboard
WC_2B1107



Lancaster Cabinet
with Drawer
WC_2B1940



Cupboard
WC_2B1940



2 Door Lancaster Cabinet
with Drawers WC_2B1941

Country Cupboards

Country cupboards are available in: maple (**m**) and oak (**k**) wood.



Corner Jelly Cupboard
WC_2B1107
19 1/4" FROM CORNER, 60 1/4"H
FLAT PANEL DOOR
4 PLATE-GROOVED SHELVES

Lancaster Cabinet
with Drawer
WC_2B1940
29"W X 56"H X 15"D
1 DRAWER
3 ADJUSTABLE SHELVES

2 Door
Lancaster Cabinet
with Drawers
WC_2B1941
49 3/4"W X 56"H X 15"D
2 DRAWERS
3 ADJUSTABLE SHELVES



Pottery Cabinet
WC_2B1946



Country Cupboards

Country cupboards available in:
maple (**m**) and oak (**k**) wood.

Pottery Cabinet
WC_2B1946
49 3/4"W X 56"H X 15"D
2 ADJUSTABLE SHELVES
STEMWARE RACK
HOLDS 4 WINE BOTTLES

1 Drawer 4 Door
Chimney
Cupboard
WC_2B1926
35"W X 72"H X 17"D
3 ADJUSTABLE SHELVES

Chimney
Cupboard
WC_2B1925
25 1/4"W X 72"H X 15"D
2 ADJUSTABLE SHELVES

4 Door
2 Drawer
Cupboard
WC_2B1942
42 1/2"W X 72"H X 15"D
3 ADJUSTABLE SHELVES



Pottery Cabinet
WC_2B1946



Chimney Cupboard
WC_2B1926



Full extension, ball-bearing
drawer glide.



Wood Knob W



Chimney Cupboard
WC_2B1925



Chimney Cupboard
WC_2B1926



Cupboard
WC_2B1942



cupboards

Make that spread look great! A Country cupboard is a charming way to store your supplies and keep them easily at hand when guests arrive.



Console WC_2B1903



Console WC_2B1905



Cabinet WC_2B1907



Stand WC_2B1908



Country Stand WC_2B1908



Pie Server WC_2B1922



Country Cabinet WC_2B1923



Pie Server WC_2B1922

Country Cupboards

Country cupboards available in: maple (m) and oak (k) wood.

Console WC_2B1903 26 1/2"W X 30"H X 12 3/4"D FLAT PANEL DOOR 1 ADJUSTABLE SHELF	Console WC_2B1906 48 1/2"W X 36"H X 12 3/4"D FLAT PANEL DOORS 1 ADJUSTABLE SHELF	Country Stand WC_2B1908 34"W X 30"H X 16"D 2 DRAWERS BEADBOARD DOORS	Country Cabinet with Drawer WC_2B1923 38 1/2"W X 35 1/4"H X 19"D RAISED PANEL DOORS 1 ADJUSTABLE SHELF
Console WC_2B1905 48 1/2"W X 30"H X 12 3/4"D FLAT PANEL DOORS 1 ADJUSTABLE SHELF	Country Cabinet WC_2B1907 43 1/4"W X 33 1/2"H X 18"D RAISED PANEL DOORS 2 ADJUSTABLE SHELVES	Pie Server WC_2B1922 WITH TIN PANELS 38 1/2"W X 35 1/4"H X 19"D 1 ADJUSTABLE SHELF 1 DRAWER	



Hutch WC_2A0811



Buffet WC_2A1606

Hutch WC_2A0809



Buffet WC_2A1606

Hutch WC_2A0810



Buffet WC_2A1607



Country Hutches & Buffets

available in: maple (m) and oak (k) wood.



Hutch with Server Area WC_2A0811

51"W X 45"H X 16 1/2"D
2 ADJUSTABLE PLATE-GROOVED
SHELVES
MULLION DOORS

3 Drawer 3 Door Buffet WC_2A1606

49 1/4"W X 34 1/4"H X 19"D
2 ADJUSTABLE SHELVES
1" THICK SOLID WOOD TOP

3 Drawer 3 Door Hutch WC_2A0809

51"W X 50"H X 16 1/2"D
2 ADJUSTABLE PLATE-GROOVED
SHELVES
MULLION DOORS

Hutch with Server Area WC_2A0810

35 3/4"W X 45"H X 16 1/2"D
1 ADJUSTABLE PLATE-GROOVED SHELF
MULLION DOORS

Buffet WC_2A1607

34"W X 34 1/4"H X 19"D
1 ADJUSTABLE SHELF
1" THICK SOLID WOOD TOP

Hutch WC_2B0817

46"W X 42"H X 13 1/2"D
2 ADJUSTABLE PLATE-GROOVED
SHELVES, MULLION DOORS

Buffet WC_2B1609

45 3/4"W X 34"H X 19 1/2"D
1 ADJUSTABLE SHELVES



Hutch WC_2B0817

Buffet WC_2B1609



Full extension, ball-bearing
drawer glide.

hutch & buffet

Hutch WC_2A0807



Buffet WC_2A1604

Hutch WC_2A0808



Buffet WC_2A1604



country

Country Hutches & Buffets

are available in: maple (**m**) and oak (**k**) wood.

4 Drawer
4 Door Hutch
WC_2A0807

65"W X 50"H X 16 1/2"D
2 ADJUSTABLE PLATE-GROOVED SHELVES
MULLION DOORS

2 Drawer
4 Door Buffet
WC_2A1604

63 1/4"W X 34 1/4"H X 19"D
2 ADJUSTABLE SHELVES
1" THICK SOLID WOOD TOP

4 Drawer
4 Door Hutch
WC_2A0808

65"W X 50"H X 16 1/2"D
2 ADJUSTABLE
PLATE-GROOVED SHELVES
MULLION DOORS

Hardware Options



Antique Brass
Knob AB



Brushed Nickel
Knob BN



Wood
Knob W



Black
Knob BL

traditional



Hutch WC_2A0801

Hutch WC_2A0804



Buffet WC_2A1601



Buffet WC_2A1602



Buffet
WC_2A1609



Full extension, ball-bearing
drawer glide.



Traditional Knob
TD

Hutch WC_2A0805



Buffet WC_2A1603

Traditional Hutches & Buffet

are available in: maple (**m**) and oak (**k**) wood.



Hutch with Server Area

WC_2A0801

38 1/2"W X 42"H X 13 1/4"D

1 ADJUSTABLE PLATE-GROOVED SHELF

2 Door Hutch with Full Length Doors

WC_2A0802 not shown

38 1/2"W X 42"H X 13 1/4"D

2 ADJUSTABLE PLATE-GROOVED SHELVES

Buffet

WC_2A1601

37 1/2"W X 34"H X 19"D

1 ADJUSTABLE SHELF

Hutch with Full Length Doors

WC_2A0804

50 1/2"W X 42"H X 13 1/4"D

4 ADJUSTABLE PLATE-GROOVED SHELVES

3 Door Hutch with Server Area

WC_2A0803 not shown

50 1/2"W X 42"H X 13 1/4"D

2 ADJUSTABLE PLATE-GROOVED SHELVES

Buffet

WC_2A1602

49 1/2"W X 34"H X 19"D

2 ADJUSTABLE SHELVES

Hutch with Server Area

WC_2A0805

MULLION DOOR OPTION (.M) SHOWN

61 1/2"W X 42"H X 13"D

2 ADJUSTABLE PLATE-GROOVED SHELVES

3 Door Hutch with Full Length Doors

WC_2A0806 not shown

61 1/2"W X 42"H X 13"D

4 ADJUSTABLE PLATE-GROOVED SHELVES

Buffet

WC_2A1603

60 1/2"W X 34"H X 19"D

2 ADJUSTABLE SHELVES

2 Door 6 Drawer Buffet

WC_2A1609

48 1/2"W X 34 3/4"H X 19"D

country corner cupboards



Country Corner Cupboards

Corner cupboards are available in:
maple (**m**) and oak (**k**) wood.



Corner Cupboard
WC_2B1101

30" FROM CORNER, 76"H
4 PLATE-GROOVED SHELVES

Corner Cupboard
with Server Area
WC_2B1103

30" FROM CORNER, 82"H
5 PLATE-GROOVED SHELVES

Corner Cupboard
with Drawer
WC_2B1105

33 3/4" FROM CORNER, 80"H
4 PLATE-GROOVED SHELVES

Corner Cupboard
WC_2B1106

33 3/4" FROM CORNER, 80"H
4 PLATE-GROOVED SHELVES

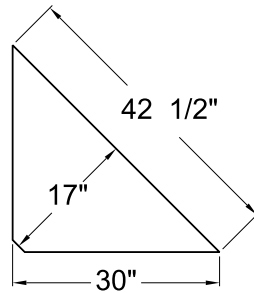

WC_2B1101
WC_2B1103

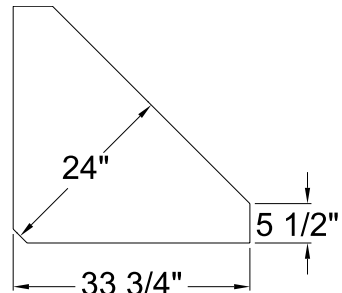

WC_2B1105
WC_2B1106



Wood
Knob W

Traditional Corner Cupboard
WC_2A1105 with optional mitered doors



Corner Cupboard
WC_2B1101



Corner Cupboard
WC_2B1103



Corner Cupboard
WC_2B1105



Corner Cupboard
WC_2B1106

traditional

WC_2A1103

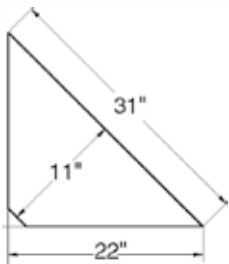

WC_2A1105

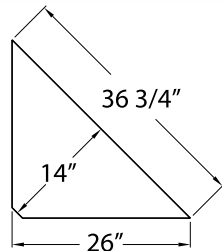

WC_2A1109

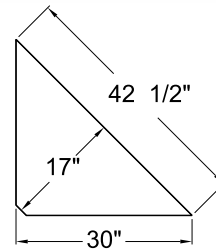

Traditional Corner Cupboards available in maple (m) and oak (k) wood.

Corner Cupboard

WC_2A1101

22" FROM CORNER, 72"H
2 DOORS, 4 PLATE-GROOVED SHELVES

WC_2A1102

26" FROM CORNER, 76"H
2 DOORS, 4 PLATE-GROOVED SHELVES

WC_2A1103 *shown*

30" FROM CORNER, 76"H
2 DOORS, 4 PLATE-GROOVED SHELVES

Corner Cupboard

WC_2A1104

22" FROM CORNER, 72"H
4 DOORS, 4 PLATE-GROOVED SHELVES

WC_2A1105 *shown*

26" FROM CORNER, 76"H
4 DOORS, 4 PLATE-GROOVED SHELVES

WC_2A1106

30" FROM CORNER, 76"H
4 DOORS, 4 PLATE-GROOVED SHELVES

Corner Cupboard

with Server Area

WC_2A1107

22" FROM CORNER, 72"H
4 PLATE-GROOVED SHELVES

WC_2A1108

26" FROM CORNER, 76"H
4 PLATE-GROOVED SHELVES

WC_2A1109

MULLION DOOR OPTION (.M) *shown*
30" FROM CORNER, 76"H
4 PLATE-GROOVED SHELVES



Products on these pages are available with optional mitered doors



corner cupboards



WC_2A1111

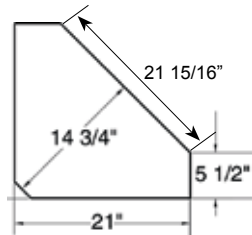

WC_2A1114

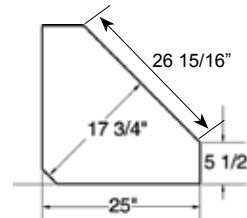

WC_2A1116

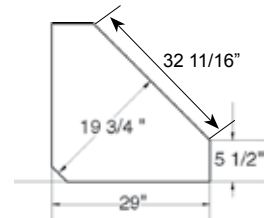

Traditional Corner Cupboards available in maple (m) and oak (k) wood.

Corner Cupboard
WC_2A1110

21" FROM CORNER, 76"H
1 DOOR, 4 PLATE-GROOVED SHELVES

WC_2A1111 *shown*

25" FROM CORNER, 78"H
2 DOORS, 4 PLATE-GROOVED SHELVES

WC_2A1112

29" FROM CORNER, 78"H
2 DOORS, 4 PLATE-GROOVED SHELVES

Corner Cupboard

WC_2A1113

21" FROM CORNER, 76"H
2 DOORS, 4 PLATE-GROOVED SHELVES

WC_2A1114 *shown*

25" FROM CORNER, 78"H
4 DOORS, 4 PLATE-GROOVED SHELVES

WC_2A1115

29" FROM CORNER, 78"H
4 DOORS, 4 PLATE-GROOVED SHELVES

Corner Cupboard
with Server Area

WC_2A1116

MULLION DOOR OPTION (.M) *shown*
21" FROM CORNER, 76"H
2 DOORS, 4 PLATE-GROOVED SHELVES

WC_2A1117

25" FROM CORNER, 78"H
4 DOORS, 4 PLATE-GROOVED SHELVES

WC_2A1118

29" FROM CORNER, 78"H
4 DOORS, 4 PLATE-GROOVED SHELVES



Traditional Knob
TD

corner cabinets



Corner Cabinet
WC_2A1119

Corner Cabinets available in maple (m) and oak (k) wood.

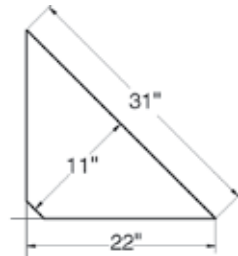

WC_2A1119

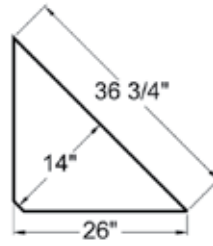

WC_2A1120

3 Sided Corner Cabinet

WC_2A1119 *shown*

22" FROM CORNER, 30 3/4"H

2 DOORS

1 FIXED PLATE-GROOVED BASE SHELF

1 FIXED PLATE-GROOVED CENTER SHELF

3 Sided Corner Cabinet

WC_2A1120

26" FROM CORNER, 30 3/4"H

2 DOORS

1 FIXED PLATE-GROOVED BASE SHELF

1 FIXED PLATE-GROOVED CENTER SHELF



Corner Cabinet
WC_2A1122

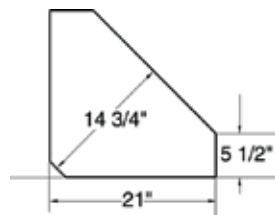

WC_2A1121

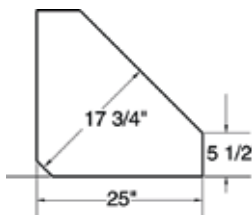

WC_2A1122

5 Sided Corner Cabinet

WC_2A1121

21" FROM CORNER, 30 3/4"H

1 DOOR

1 FIXED PLATE-GROOVED BASE SHELF

1 FIXED PLATE-GROOVED CENTER SHELF

5 Sided Corner Cabinet

WC_2A1122 *shown*

25" FROM CORNER, 30 3/4"H

2 DOORS

1 FIXED PLATE-GROOVED BASE SHELF

1 FIXED PLATE-GROOVED CENTER SHELF

kitchen carts



Kitchen Carts available in maple (m) and oak (k) wood.

Cart SC_2A1901

29 1/2"W X 36"H X 18 3/4"D

1 ADJUSTABLE SHELF

CASTERS



Cart SC_2A1901

Cart SC_2A1902

29 1/2"W X 56"H X 18 3/4"D

1 ADJUSTABLE SHELF

OPENING: 24 1/2"W X 18"H

CASTERS



Cart SC_2A1902

Cart SC_2A1903

29 1/2"W X 72"H X 18 3/4"D

1 ADJUSTABLE SHELF

OPENING: 24 1/2"W X 18"H

CASTERS



Cart SC_2A1903

wine cabinets



Wine Cabinets available in maple (**m**) and oak (**k**) wood.

1 Drawer
Wine Cabinet
WC_2A2701
37 1/2"W X 36 3/4"H X 17"D
HOLDS 28, 750 ML WINE BOTTLES

1 Drawer 2 Door
Wine Cabinet
WC_2A2702
37 1/2"W X 36 3/4"H X 17"D
HOLDS 28, 750 ML WINE BOTTLES



Bin WC_2A1903

Bin WC_2A1904



Bin WC_2A1905

recycling bins



Recycling Bins available in maple (**m**) and oak (**k**) wood.

Recycling Bin
WC_2A1903
19"W X 32"H X 17 1/4"D
1 PLASTIC CAN INCLUDED

2 Door Recycling Bin
WC_2A1904
35 1/4"W X 32"H X 17 1/4"D
2 PLASTIC CANS INCLUDED

3 Door Recycling Bin
WC_2A1905
51 1/2"W X 32"H X 17 1/4"D
3 PLASTIC CANS INCLUDED



Full extension, ball-bearing
drawer glide.



Traditional Knob
TD



Cottage Kitchen Island WC_2E1701S



Country Kitchen Island WC_2B1728



Cottage Kitchen Island WC_2E1702S



Country Kitchen Island WC_2B1729



Shaker Kitchen Island WC_2D1706



Country Kitchen Island WC_2B1730



Shaker Kitchen Island WC_2D1707



Country Kitchen Island WC_2B1731

kitchen Islands

Our islands are a great way to add extra storage, prep and seating space. Finish your way and make an inviting place look in your kitchen or dining room.

Cottage Kitchen Islands

available in maple (**m**) wood

Kitchen Island
WC_2E1701S SOLID
 48"W X 36 3/4"H X 24 3/4"D
 36"D OVERSIZED SOLID WOOD TOP
 1 ADJUSTABLE SHELF
 4 DRAWERS



Kitchen Island
WC_2E1702S SOLID
 60"W X 36 3/4"H X 24 3/4"D
 36"D OVERSIZED SOLID WOOD TOP
 2 ADJUSTABLE SHELVES
 4 DRAWERS

Shaker Kitchen Islands

available in maple (**m**), oak (**k**), and cherry (**c**) wood.

Kitchen Island
WC_2D1706
 48"W X 36 3/4"H X 23 1/4"D
 36"D OVERSIZED SOLID WOOD TOP
 1 ADJUSTABLE SHELF
 4 DRAWERS



Kitchen Island
WC_2D1707
 60"W X 36 3/4"H X 23 1/4"D
 SOLID WOOD TOP
 2 ADJUSTABLE SHELVES
 4 DRAWERS



Country Kitchen Islands

available in maple (**m**) and oak (**k**) wood.



Kitchen Island
WC_2B1728
 48"W X 36 3/4"H X 22 1/4"D
 24"D SOLID WOOD TOP
 1 ADJUSTABLE SHELF
 3 DRAWERS



Full extension, ball-bearing drawer glide.

Kitchen Island
WC_2B1729
 48"W X 36 3/4"H X 22 1/4"D
 36"D OVERSIZED SOLID WOOD TOP
 1 ADJUSTABLE SHELF
 3 DRAWERS



Wood Knob W

Kitchen Island
WC_2B1730
 60"W X 36 3/4"H X 22 1/4"D
 24"D SOLID WOOD TOP
 1 ADJUSTABLE SHELF
 4 DRAWERS

Kitchen Island
WC_2B1731
 60"W X 36 3/4"H X 22 1/4"D
 36"D OVERSIZED SOLID WOOD TOP
 1 ADJUSTABLE SHELF
 4 DRAWERS

benches

Country Benches

available in maple (**m**) and oak (**k**) wood.



Deacon's Storage Bench WC_2N0201

Deacon's Storage
Bench
WC_2N0201
39 3/4"W X 30 1/2"H X 16 3/4"D
LID SUPPORT
BANDED TOP

Bench
WC_2N2602
48"W X 17"H X 13"D

Bench
WC_2N2603
60"W X 17"H X 13"D

Bench
WC_2N2601
36"W X 17"H X 13"D



Country Bench WC_2N2601



Country Bench WC_2N2602

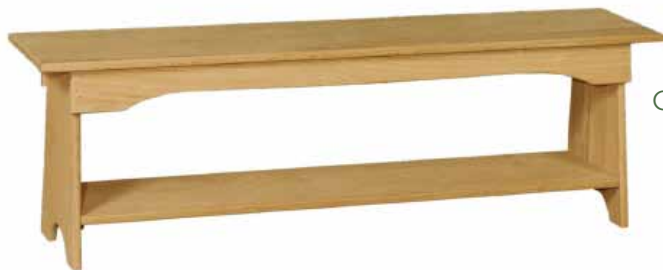

Country Bench WC_2N2603

display cases

Pier Cases

available in maple (**m**) and oak (**k**) wood.



Pier Case WC_2B2101



Double Pier Case WC_2B2102

Pier Case
WC_2B2101
20"W X 63"H X 12"D

Double Pier Case
WC_2B2102
38 1/2"W X 63"H X 12"D

curios



Curios

available in maple (**m**) and oak (**k**) wood.



2 Door Curio
WC_2A2101
21 1/2"W X 76"H X 16 1/4"D
ADJUSTABLE GLASS SHELVES
INTERIOR DISPLAY LIGHTS
MODIFY IN HEIGHT ONLY

4 Door Curio
WC_2A2102
38"W X 76"H X 16 1/4"D
ADJUSTABLE GLASS SHELVES
INTERIOR DISPLAY LIGHTS
MODIFY IN HEIGHT ONLY

gun cabinets



Locking Gun Cabinets

available in maple (**m**) and oak (**k**) wood.



10 Gun Cabinet
WC_2A2204

6 Gun Cabinet
WC_2A2202

6 Gun Cabinet
WC_2A2202

8 Gun Cabinet
WC_2A2203
32 1/2"W X 72"H X 16"D
2 GLASS DOORS
2 RAISED PANEL DOORS
2 DOUBLE BARREL SLOTS
4 LOCKS

6 Gun Cabinet
WC_2A2202
26 1/2"W X 72"H X 16"D
1 GLASS DOOR
1 RAISED PANEL DOOR
1 DOUBLE BARREL SLOT
2 LOCKS

10 Gun Cabinet
WC_2A2204 *shown*
38 1/2"W X 72"H X 16"D
2 GLASS DOORS
2 RAISED PANEL DOORS
2 DOUBLE BARREL SLOTS
4 LOCKS

6 Gun Cabinet
WC_2A2201
25 1/2"W X 66"H X 12 3/4"D
1 DOUBLE BARREL SLOT
1 FIXED SHELF
1 LOCKING COMBINATION DOOR

12 Gun Cabinet
WC_2A2205
44 1/2"W X 72"H X 16"D
2 GLASS DOORS
2 RAISED PANEL DOORS
2 DOUBLE BARREL SLOTS
4 LOCKS



Traditional Knob

semi custom

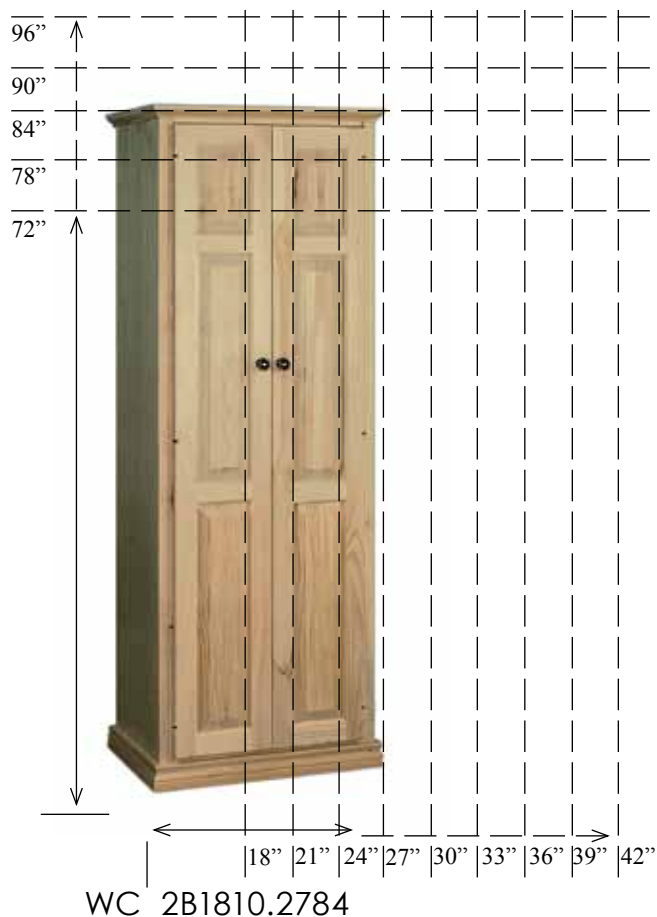
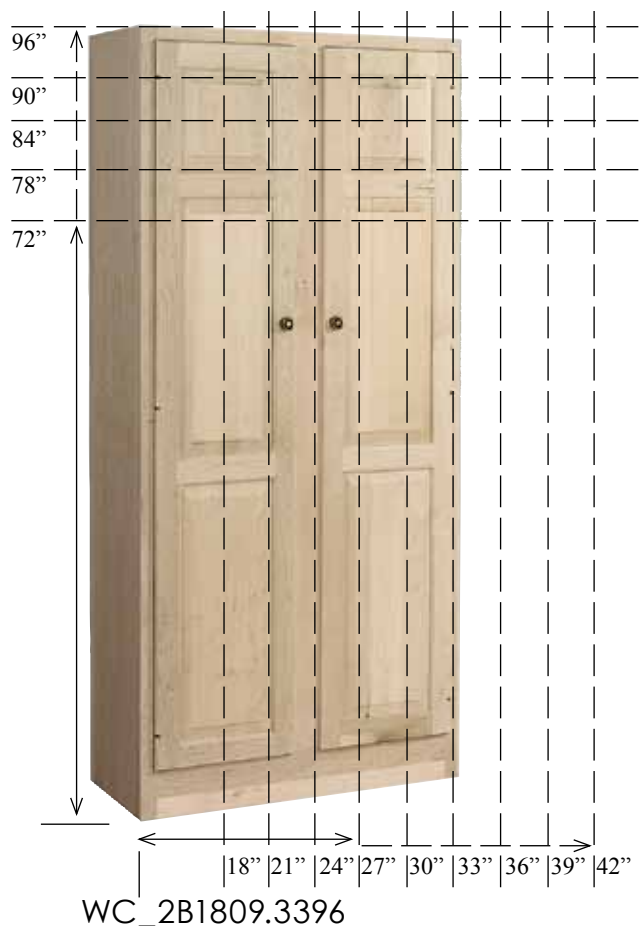

Ordering Info: to order semi-custom Pantry Cabinets add the width, then the height after the model number.

WCM2B1809.3396 Maple Pantry is 33" w x 96" h x 12" d.

WCK2B1810.2784 Oak Pantry is 27" w x 84" h x 12 3/4" d.

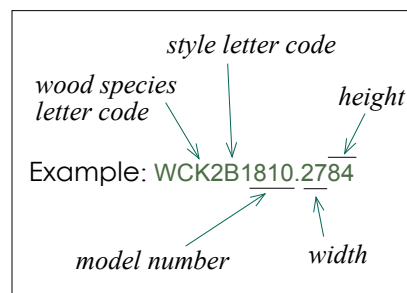
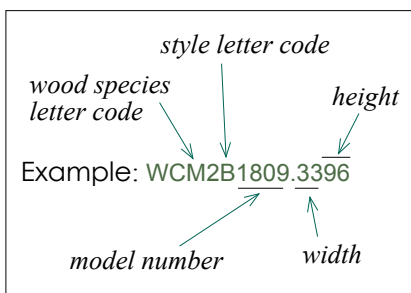

Depth Modification is available by request.

Under 24 Inches Wide:

1 door
5 adjustable shelves

Over 24 Inches Wide:

2 doors
5 adjustable shelves

Over 30 Inches Wide:

2 doors,
center stile
1 fixed shelf
4 adjustable shelves

pantry cabinets

Woodcraft offers semi-custom storage options
built to fit your particular space.

Semi-Custom Pantry

available in maple (**m**) and oak (**k**) wood.



12" deep Pantry Cabinets

WC_2B1807

18"W X 72"H X 12"D
1 DOOR
5 ADJUSTABLE SHELVES

WC_2B1809

24"W X 72"H X 12"D
2 DOORS
5 ADJUSTABLE SHELVES

WC_2B1811

30"W X 72"H X 12"D
2 DOORS
CENTER STILE
1 FIXED SHELF
4 ADJUSTABLE SHELVES

WC_2B1813 *shown*

36"W X 72"H X 12"D
2 DOORS, CENTER STILE
1 FIXED SHELF
4 ADJUSTABLE SHELVES

16" deep Pantry Cabinets

WC_2B1815

18"W X 72"H X 16"D
1 DOOR
5 ADJUSTABLE SHELVES

WC_2B1817

24"W X 72"H X 16"D
2 DOORS
5 ADJUSTABLE SHELVES

WC_2B1819

30"W X 72"H X 16"D
2 DOORS, CENTER STILE
1 FIXED SHELF
4 ADJUSTABLE SHELVES

WC_2B1821

36"W X 72"H X 16"D
2 DOORS, CENTER STILE
1 FIXED SHELF
4 ADJUSTABLE SHELVES



Traditional Knob

12 3/4" deep Pantry Cabinets with Trim

WC_2B1808

19 1/2"W X 72"H X 12 3/4"D
1 door
5 adjustable shelves

WC_2B1810 *shown*

25 1/2"W X 72"H X 12 3/4"D
2 doors
5 adjustable shelves

WC_2B1812

31 1/2"W X 72"H X 12 3/4"D
2 DOORS, CENTER STILE
1 FIXED SHELF
4 ADJUSTABLE SHELVES

WC_2B1814

37 1/2"W X 72"H X 12 3/4"D
2 DOORS, CENTER STILE
1 FIXED SHELF
4 ADJUSTABLE SHELVES

16 3/4" deep Pantry Cabinets with Trim

WC_2B1816

19 1/2"W X 72"H X 16 3/4"D
1 DOOR
5 ADJUSTABLE SHELVES

WC_2B1818

25 1/2"W X 72 3/4"H X 16 3/4"D
2 DOORS
5 ADJUSTABLE SHELVES

WC_2B1820

31 1/2"W X 72"H X 16 3/4"D
2 DOORS, CENTER STILE
1 FIXED SHELF
4 ADJUSTABLE SHELVES

WC_2B1822

37 1/2"W X 72"H X 16 3/4"D
2 DOORS, CENTER STILE
1 FIXED SHELF
4 ADJUSTABLE SHELVES



semi custom

Ordering Info: to order semi-custom cabinets add the width, then the height after the model number.
Depth Modifications are available.



WCK2B1907.3642 Oak Cupboard is 36" w x 42" h x 18" d.

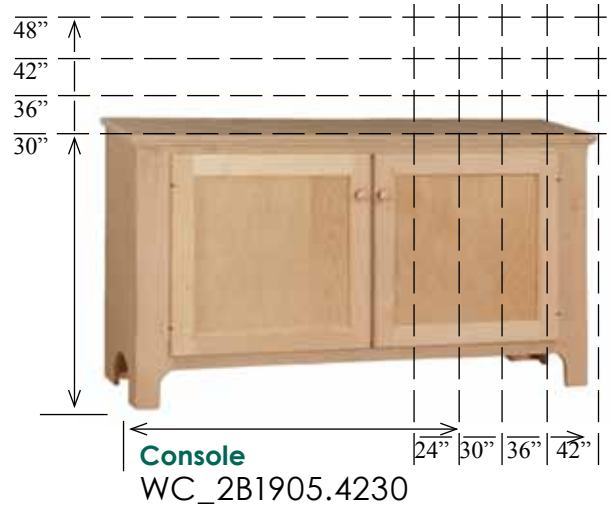

WCM2B1905.4230 Maple Console is 42" w x 30" h x 12 3/4" d.

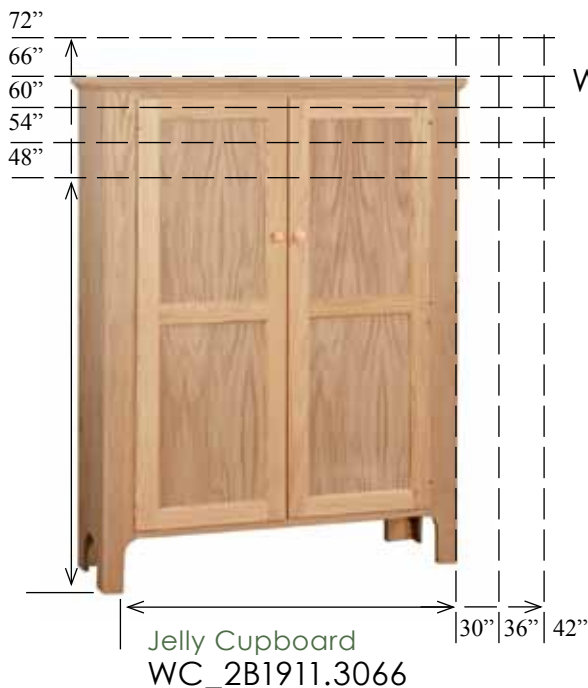
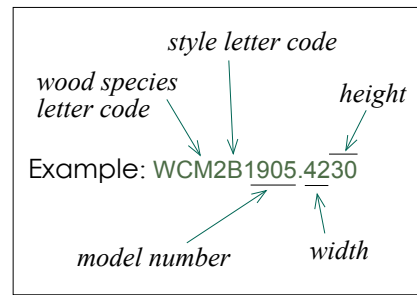
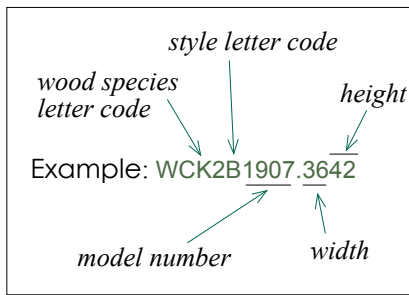

WCK2B1911.3066 Oak Cupboard is 30" w x 66" h x 12 3/4" d.

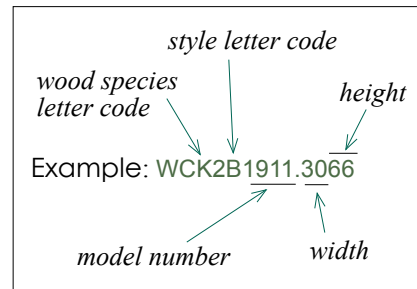

Wood Knob W

storage

Semi-Custom Storage Cabinets

are available in maple (**m**) and oak (**k**) wood.

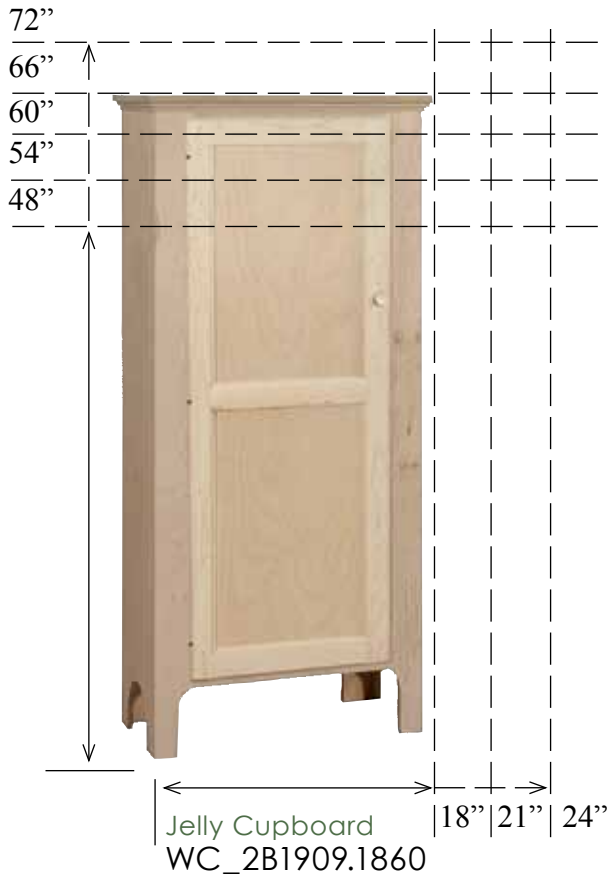

WCM2B1909.1860

Maple Cupboard is 18" w x 60" h x 12 3/4" d

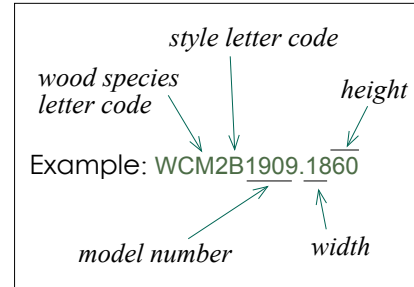

Ordering Info: to order semi-custom cabinets add the width, then the height after the model number.

Depth Modifications
are available.



WCM2B2102.3663

Maple Console is 36" w x 63" h x 12" d

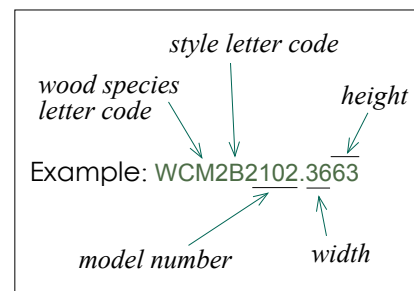

wall cabinets

available in maple (m), oak (k) and cherry (c)wood.



Display Cabinet
maple only



Display Cabinet
with shelf
maple only



Display Cabinet
with door



Display Cabinet
with door
and shelf



Display Cabinet
with drawers
maple only



Display Cabinet
with door
and drawers



Keepsake Shelf



Keepsake Shelf
with pegs



close up of peg

Display Cabinets

Model #	Description	W	H	D	Doors / Drawers
DC_1836 B or S	Display Cabinet 18"w	19 1/2"	36"	9 3/4"	0/0
DC_2436 B or S	Display Cabinet 24"w	25 1/2"	36"	9 3/4"	0/0
DC_3036 B or S	Display Cabinet 30"w	31 1/2"	36"	9 3/4"	0/0
DC_3636 B or S	Display Cabinet 36"w	37 1/2"	36"	9 3/4"	0/0

Display Cabinets with Shelf

DC_1836S B or S	Display Cabinet 18"w with Shelf	19 1/2"	36"	9 3/4"	0/0
DC_2436S B or S	Display Cabinet 24"w with Shelf	25 1/2"	36"	9 3/4"	0/0
DC_3036S B or S	Display Cabinet 30"w with Shelf	31 1/2"	36"	9 3/4"	0/0
DC_3636S B or S	Display Cabinet 36"w with Shelf	37 1/2"	36"	9 3/4"	0/0

Display Cabinets with Doors *specify door type, doors shown on page 61*

DC_1836D_B or S	Display Cabinet 18"w with Doors	19 1/2"	36"	9 3/4"	1/0
DC_2436D_B or S	Display Cabinet 24"w with Doors	25 1/2"	36"	9 3/4"	1/0
DC_3036D_B or S	Display Cabinet 30"w with Doors	31 1/2"	36"	9 3/4"	2/0
DC_3636D_B or S	Display Cabinet 36"w with Doors	37 1/2"	36"	9 3/4"	2/0

Display Cabinets with Shelf & Doors *specify door type, doors shown on page 61*

DC_1836D_S B or S	Display Cabinet 18"w with Shelf and Doors	19 1/2"	36"	9 3/4"	1/0
DC_2436D_S B or S	Display Cabinet 24"w with Shelf and Doors	25 1/2"	36"	9 3/4"	1/0
DC_3036D_S B or S	Display Cabinet 30"w with Shelf and Doors	31 1/2"	36"	9 3/4"	2/0
DC_3636D_S B or S	Display Cabinet 36"w with Shelf and Doors	37 1/2"	36"	9 3/4"	2/0

Display Cabinet with Drawers

DCD_1836 B or S	Display Cabinet 18"w with Drawers	19 1/2"	36"	9 3/4"	0/1
DCD_2436 B or S	Display Cabinet 24"w with Drawers	25 1/2"	36"	9 3/4"	0/1
DCD_3036 B or S	Display Cabinet 30"w with Drawers	31 1/2"	36"	9 3/4"	0/2
DCD_3636 B or S	Display Cabinet 36"w with Drawers	37 1/2"	36"	9 3/4"	0/2

Display Cabinet with Doors & Drawers *specify door type, doors shown on page 61*

DCD_1836D_B or S	Display Cabinet 18"w with Drawers & Doors	19 1/2"	36"	9 3/4"	1/1
DCD_2436D_B or S	Display Cabinet 24"w with Drawers & Doors	25 1/2"	36"	9 3/4"	1/1
DCD_3036D_B or S	Display Cabinet 30"w with Drawers & Doors	31 1/2"	36"	9 3/4"	2/2
DCD_3636D_B or S	Display Cabinet 36"w with Drawers & Doors	37 1/2"	36"	9 3/4"	2/2

Model #	Description	W	H	D	Pegs
---------	-------------	---	---	---	------

Keepsake Shelves

KS_18 B or S	Keepsake Shelf 18"w	19 1/2"	24"	7"	-
KS_24 B or S	Keepsake Shelf 24"w	25 1/2"	24"	7"	-
KS_30 B or S	Keepsake Shelf 30"w	31 1/2"	24"	7"	-
KS_36 B or S	Keepsake Shelf 36"w	37 1/2"	24"	7"	-

Keepsake Shelves with Pegs

KPS_18 B or S	Keepsake Shelf with Pegs 18"w	19 1/2"	24"	7"	3
KPS_24 B or S	Keepsake Shelf with Pegs 24"w	25 1/2"	24"	7"	4
KPS_30 B or S	Keepsake Shelf with Pegs 30"w	31 1/2"	24"	7"	5
KPS_36 B or S	Keepsake Shelf with Pegs 36"w	37 1/2"	24"	7"	6

wall cabinets

available in maple (**m**), oak (**k**) and cherry (**c**) wood.

Medicine Cabinets

Model #	Description	W	H	D
Medicine Cabinets See ordering information below				
BC_1824__B or S	Medicine Cabinet 18"w	19 1/2"	24"	6 1/4"
BC_2424__B or S	Medicine Cabinet 24"w	25 1/2"	24"	6 1/4"
BC_3024__B or S	Medicine Cabinet 30"w	31 1/2"	24"	6 1/4"
BC_3624__B or S	Medicine Cabinet 36"w	37 1/2"	24"	6 1/4"
BC_1830__B or S	Medicine Cabinet 18"w	19 1/2"	30"	6 1/4"
BC_2430__B or S	Medicine Cabinet 24"w	25 1/2"	30"	6 1/4"
BC_3030__B or S	Medicine Cabinet 30"w	31 1/2"	30"	6 1/4"
BC_3630__B or S	Medicine Cabinet 36"w	37 1/2"	30"	6 1/4"
BC_1836__B or S	Medicine Cabinet 18"w	19 1/2"	36"	6 1/4"
BC_2436__B or S	Medicine Cabinet 24"w	25 1/2"	36"	6 1/4"
BC_3036__B or S	Medicine Cabinet 30"w	31 1/2"	36"	6 1/4"
BC_3636__B or S	Medicine Cabinet 36"w	37 1/2"	36"	6 1/4"

Toilet Toppers Specify door type

TT_2436__B or S	Toilet Topper 24"w	25 1/2"	36"	9 3/4"
TT_3036__B or S	Toilet Topper 30"w	31 1/2"	36"	9 3/4"
TT_3636__B or S	Toilet Topper 36"w	37 1/2"	36"	9 3/4"

NOTE: Medicine cabinets 24" and under have one door. **Specify Hinge Left or Hinge Right.**

Choice of: **B = Banded Top, S = Solid Top**



Medicine Cabinet with shelf



Medicine Cabinet with bar



Medicine Cabinet with box bottom



Toilet Topper

Door Options



Flat Panel Door



Raised Panel Door



Beadboard Panel Door
maple only



Glass/Mirror Door

Helpful Cabinet Ordering Information

Example Model Number

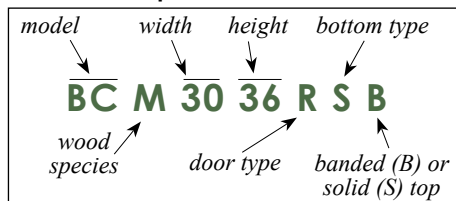

Bottom Type Codes

S = Shelf Bottom
B = Bar Bottom
N = Box Bottom

Add the code at the end of the model number for your door and bottom options.

Door Type Codes

F = Flat Panel
R = Raised Panel
B = Beadboard
G = Glass
M = Mirror

wall accessories

available in maple (m), oak (k) and cherry (c)wood.



Mirror



Mirror with shelf



Mirror with shelf and pegs



Peg Rack

Mirrors

Model # Description W H D Pegs

Mirror

OM_2133S	Mirror 21"w	21"	33"	1 3/4"	-
OM_2433S	Mirror 24"w	24"	33"	1 3/4"	-

Mirror with Shelf

MS_2633S	Mirror with Shelf 26"w	26"	33"	6 1/4"	-
----------	------------------------	-----	-----	--------	---

Mirror with Shelf and Pegs

MPS_2633S	Mirror with Shelf & Pegs 26"w	26"	33"	6 1/4"	3
-----------	-------------------------------	-----	-----	--------	---

Peg Racks

Model # Description W H D Pegs

PR_12S	Peg Rack	12"	3 1/2"	3/4"	2
PR_18S	Peg Rack	18"	3 1/2"	3/4"	3
PR_24S	Peg Rack	24"	3 1/2"	3/4"	4
PR_30S	Peg Rack	30"	3 1/2"	3/4"	5
PR_36S	Peg Rack	36"	3 1/2"	3/4"	6
PR_42S	Peg Rack	42"	3 1/2"	3/4"	7
PR_48S	Peg Rack	48"	3 1/2"	3/4"	8
PR_60S	Peg Rack	60"	3 1/2"	3/4"	10
PR_72S	Peg Rack	72"	3 1/2"	3/4"	12

Lancaster Shelves

Model #	Description	W	H	D
Lancaster Wall Shelves				
LS_18 B or S	Lancaster Wall Shelf	18"	4 1/4"	6 3/4"
LS_24 B or S	Lancaster Wall Shelf	24"	4 1/4"	6 3/4"
LS_30 B or S	Lancaster Wall Shelf	30"	4 1/4"	6 3/4"
LS_36 B or S	Lancaster Wall Shelf	36"	4 1/4"	6 3/4"
LS_42 B or S	Lancaster Wall Shelf	42"	4 1/4"	6 3/4"
LS_48 B or S	Lancaster Wall Shelf	48"	4 1/4"	6 3/4"
LS_60 B or S	Lancaster Wall Shelf	60"	4 1/4"	6 3/4"
LS_72 B or S	Lancaster Wall Shelf	72"	4 1/4"	6 3/4"

Model #	Description	W	H	D
Lancaster Corner Wall Shelves				
LCS_12 B or S	Lancaster Corner Shelf	12 5/8" along wall	4 1/4"	18" across front
LCS_17 B or S	Lancaster Corner Shelf	17 5/8" along wall	4 1/4"	25" across front
LCS_25 B or S	Lancaster Corner Shelf	25 5/8" along wall	4 1/4"	36" across front



Lancaster Corner Wall Shelf



Lancaster Wall Shelf

Choice of: **B = Banded Top** **S = Solid Wood Top**

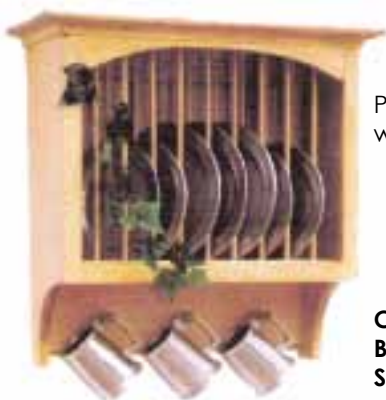

Plate Rack with Pegs

Choice of:
B = Banded Top
S = Solid Wood Top

Plate Racks

Model # Description W H D Pegs/Plate Rack

PR_2424 B or S	Plate Rack 24"	25 1/2"	24"	11"	0/10
PR_3024 B or S	Plate Rack 30"	31 1/2"	24"	11"	0/12
PR_3624 B or S	Plate Rack 36"	37 1/2"	24"	11"	0/16

Plate Racks with Pegs

PPR_2424 B or S	Plate Rack with Pegs 24"	24"	24"	11"	4/10
PPR_3024 B or S	Plate Rack with Pegs 30"	31 1/2"	24"	11"	5/12
PPR_3624 B or S	Plate Rack with Pegs 36"	37 1/2"	24"	11"	6/16



& shelving

available in maple (m), oak (k) and cherry (c) wood.



Country Wall Shelf



Shaker Wall Shelf with Pegs

Wall Shelves

Model #	Description	W	H	D	Pegs	Model #	Description	W	H	D	Pegs
Country Wall Shelves						Shaker Wall Shelves					
CS_12 B or S	Shelf	12"	6 3/4"	6 3/4"	-	SS_12 B or S	Shelf	12"	4 3/4"	6 3/4"	-
CS_18 B or S	Shelf	18"	6 3/4"	6 3/4"	-	SS_18 B or S	Shelf	18"	4 3/4"	6 3/4"	-
CS_24 B or S	Shelf	24"	6 3/4"	6 3/4"	-	SS_24 B or S	Shelf	24"	4 3/4"	6 3/4"	-
CS_30 B or S	Shelf	30"	6 3/4"	6 3/4"	-	SS_30 B or S	Shelf	30"	4 3/4"	6 3/4"	-
CS_36 B or S	Shelf	36"	6 3/4"	6 3/4"	-	SS_36 B or S	Shelf	36"	4 3/4"	6 3/4"	-
CS_42 B or S	Shelf	42"	6 3/4"	6 3/4"	-	SS_42 B or S	Shelf	42"	4 3/4"	6 3/4"	-
CS_48 B or S	Shelf	48"	6 3/4"	6 3/4"	-	SS_48 B or S	Shelf	48"	4 3/4"	6 3/4"	-
CS_60 B or S	Shelf	60"	6 3/4"	6 3/4"	-	SS_60 B or S	Shelf	60"	4 3/4"	6 3/4"	-
CS_72 B or S	Shelf	72"	6 3/4"	6 3/4"	-	SS_72 B or S	Shelf	72"	4 3/4"	6 3/4"	-



close up of peg

Country Wall Shelves with Pegs

CPS_12 B or S	Shelf w Pegs	12"	6 3/4"	6 3/4"	2
CPS_18 B or S	Shelf w Pegs	18"	6 3/4"	6 3/4"	3
CPS_24 B or S	Shelf w Pegs	24"	6 3/4"	6 3/4"	4
CPS_30 B or S	Shelf w Pegs	30"	6 3/4"	6 3/4"	5
CPS_36 B or S	Shelf w Pegs	36"	6 3/4"	6 3/4"	6
CPS_42 B or S	Shelf w Pegs	42"	6 3/4"	6 3/4"	7
CPS_48 B or S	Shelf w Pegs	48"	6 3/4"	6 3/4"	8
CPS_60 B or S	Shelf w Pegs	60"	6 3/4"	6 3/4"	10
CPS_72 B or S	Shelf w Pegs	72"	6 3/4"	6 3/4"	12

Shaker Wall Shelves with Pegs

SPS_12 B or S	Shelf w Pegs	12"	4 3/4"	6 3/4"	2
SPS_18 B or S	Shelf w Pegs	18"	4 3/4"	6 3/4"	3
SPS_24 B or S	Shelf w Pegs	24"	4 3/4"	6 3/4"	4
SPS_30 B or S	Shelf w Pegs	30"	4 3/4"	6 3/4"	5
SPS_36 B or S	Shelf w Pegs	36"	4 3/4"	6 3/4"	6
SPS_42 B or S	Shelf w Pegs	42"	4 3/4"	6 3/4"	7
SPS_48 B or S	Shelf w Pegs	48"	4 3/4"	6 3/4"	8
SPS_60 B or S	Shelf w Pegs	60"	4 3/4"	6 3/4"	10
SPS_72 B or S	Shelf w Pegs	72"	4 3/4"	6 3/4"	12

Choice of: **B = Banded Top** **S = Solid Wood Top**

Tavern Shelves

Model #	Description	W	H	D	Pegs
Single Tavern Shelf with Pegs					
TS_1207 B or S	Tavern Shelf with Pegs	12"	8 3/4"	5 1/2"	2
TS_1807 B or S	Tavern Shelf with Pegs	18"	8 3/4"	5 1/2"	3
TS_2407 B or S	Tavern Shelf with Pegs	24"	8 3/4"	5 1/2"	4
TS_3007 B or S	Tavern Shelf with Pegs	30"	8 3/4"	5 1/2"	5
TS_3607 B or S	Tavern Shelf with Pegs	36"	8 3/4"	5 1/2"	6
TS_4207 B or S	Tavern Shelf with Pegs	42"	8 3/4"	5 1/2"	7

Double Tavern Shelf with Pegs

TS_1220 B or S	Tavern Shelf with Pegs	12"	17"	5 1/2"	2
TS_1820 B or S	Tavern Shelf with Pegs	18"	17"	5 1/2"	3
TS_2420 B or S	Tavern Shelf with Pegs	24"	17"	5 1/2"	4
TS_3020 B or S	Tavern Shelf with Pegs	30"	17"	5 1/2"	5
TS_3620 B or S	Tavern Shelf with Pegs	36"	17"	5 1/2"	6
TS_4220 B or S	Tavern Shelf with Pegs	42"	17"	5 1/2"	7



Double Tavern Shelf



Single Tavern Shelf



Triple Tavern Shelf

Triple Tavern Shelf with Pegs

TS_1224 B or S	Tavern Shelf with Pegs	12"	26"	5 1/2"	2
TS_1824 B or S	Tavern Shelf with Pegs	18"	26"	5 1/2"	3
TS_2424 B or S	Tavern Shelf with Pegs	24"	26"	5 1/2"	4
TS_3024 B or S	Tavern Shelf with Pegs	30"	26"	5 1/2"	5
TS_3624 B or S	Tavern Shelf with Pegs	36"	26"	5 1/2"	6
TS_4224 B or S	Tavern Shelf with Pegs	42"	26"	5 1/2"	7

Choice of: **B = Banded Top** **S = Solid Wood Top**